

CHAINAGE	0.000	2.000	4.000	6.000	8.000	10.000	12.000	14.000	16.000	18.000	20.000	22.000	24.000	26.000	28.000	30.000	32.000	34.000	36.000	38.000	40.000	42.000	44.000	46.000	48.000	50.000	52.000	54.000	56.000	57.042
EXISTING GROUND LEVEL	69.947	69.943	69.939	69.935	69.939	69.944	69.949	69.965	69.986	70.007	70.028	70.020	69.997	69.979	69.962	69.946	69.929	69.921	69.913	69.906	69.894	69.878	69.881	69.917	69.947	69.862	69.333	69.699	69.654	69.630
PROPOSED GROUND LEVEL	70.40	70.40	68.90	68.90	68.90	68.90	68.90	68.90	68.90	68.90	68.90	68.90	68.90	68.90	68.90	68.90	68.90	68.90	68.90	68.90	68.90	68.90	68.90	68.90	68.90	68.90	68.90	68.90	68.90	68.90

POND 1 - SECTION 1

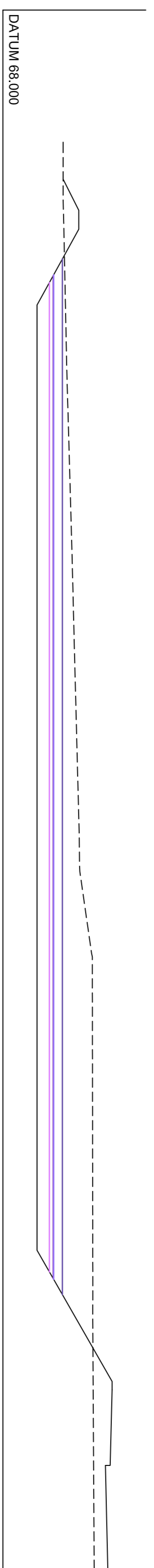

CHAINAGE	0.000	2.000	4.000	6.000	8.000	10.000	12.000	14.000	16.000	18.000	20.000	22.000	24.000	26.000	28.000	30.000	32.000	34.000	36.000	38.000	40.000	41.272
EXISTING GROUND LEVEL	69.588	69.588	69.588	69.612	69.653	69.698	69.754	69.811	69.862	69.913	69.965	70.015	70.202	70.359	70.362	70.365	70.368	70.370	70.377	70.388	70.400	70.407
PROPOSED GROUND LEVEL	70.00	70.00	70.00	70.00	70.00	70.00	70.00	70.00	70.00	70.00	70.00	70.00	70.00	70.00	70.00	70.00	70.00	70.00	70.00	70.00	70.00	70.00

POND 1 - SECTION 1

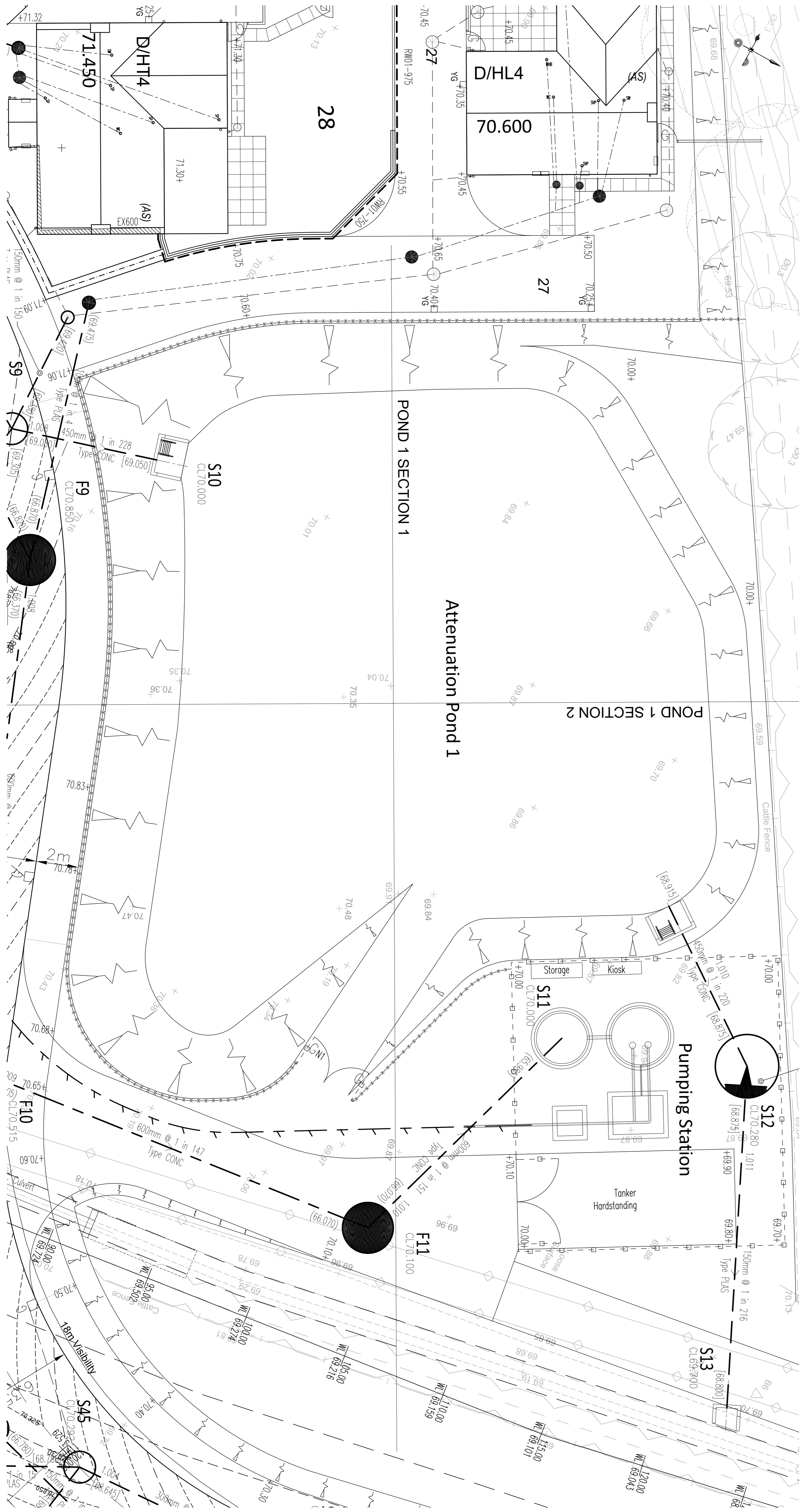

DO NOT SCALE FROM THIS DRAWING
 All dimensions to be checked on site prior to construction of proposed items. Any discrepancy or omission shall be reported immediately to the Project Manager. The Project Manager shall be responsible for the accuracy of all dimensions and levels. The Project Manager shall be responsible for the accuracy of all dimensions and levels. The Project Manager shall be responsible for the accuracy of all dimensions and levels. © 2018 Newland Homes Ltd

Storm Water Levels
 1in 100 Yr +30%
 1in 30 Yr
 1in 1 Yr

1. Refer to drawings:
 208-122-3 for details of the inlet / outlet and control chamber.
 208-144-2 for details of the steep slope and drawdown zone.

NEW

Newland HOMES

Collin Lane,
 Willersey
 Attenuation Pond 1
 Plan and Sections

1:100 @ A1
 209 - 144 - 01

DATE INITIAL

BJ
 29.01.16
 29.01.16
 29.01.16